

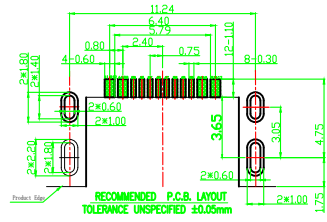

REV.	ECN. NO.	DESCRIPTION	ENG	DATE
A				

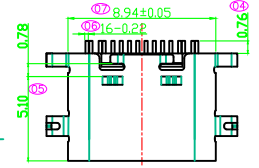

- 注:
1. 工作电压:100 VAC.
 2. 工作电流:5.0A MAX.
 3. 操作温度: -30° C~+85° C
 3. 有标示“○”符号者全检尺寸.
有标示“▲”符号者为CTQ管控尺寸.
 4. 有标示“▽”记号者为CPK管控尺寸.
 5. 插入力: 5-20N. 拔出力: 8-20N.
 6. 绝缘阻抗: 100MΩ Min.
 7. 接触阻抗 40 mΩ MAX.
 8. 插拔寿命 10000 次.

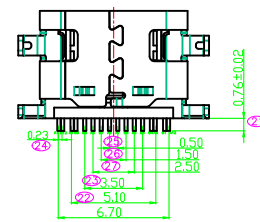
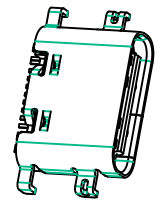
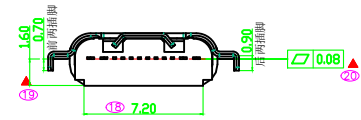
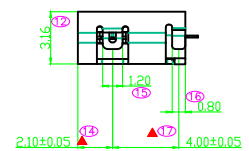
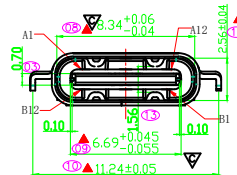
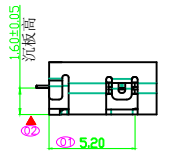

A1	GND	B12	GND
A4	VBUS	B9	VBUS
A5	CC1	B8	SBU2
A6	DP1	B7	DN2
A7	DN1	B6	DP2
A8	SBU1	B5	CC2
A9	VBUS	B4	VBUS
A12	GND	B1	GND
PIN	SIGNAL NAME	PIN	SIGNAL NAME

5	外壳	1 PC	SUS201-1/2H, t=0.30
4	上排接触端子	8pc/set	C7025-TOM03, t=0.12
3	下排接触端子	8pc/set	C7025-TOM03, t=0.12
2	中钢片+挂钩	1 PC	SUS301- H, t=0.15
1	MD半成品胶芯	1 PC	LCP - BK
项次	零件名称	数量	材质

DESIGN	MISS ZENG	SC ALL	
DRAWIGN	MISS LI	ANIT	MM
CHECK	Mr. ZENG	SIZE	A4: 210*297
APPROVAL		VERSION	01

未注公差 TOLERANCE	
X. ±0.50	X°. ±2°
X. ±0.30	X°. ±1°
.XX ±0.20	.XX° ±0.5°
.XXX ±0.10	

品名: 连接器
 型号: ASSEMBLY DRAWING
 C F 单排16P, 沉板1.60 CONN

东莞市航宏电子科技有限公司
 Dongguan Hanghong Electronics Co., Ltd.